

Pratt
(a)

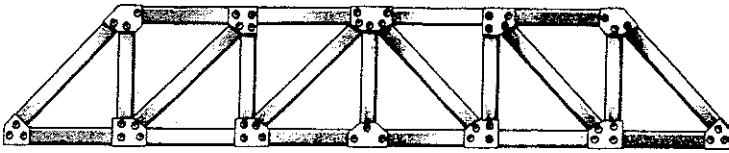

Howe
(b)

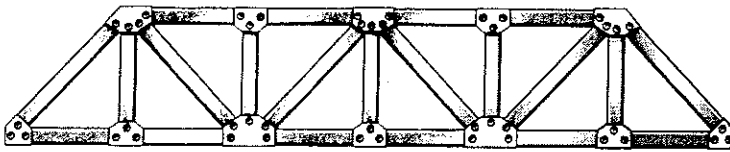

Warren (with verticals)
(c)

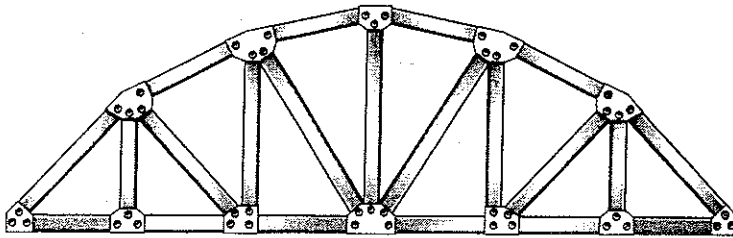

Parker
(d)

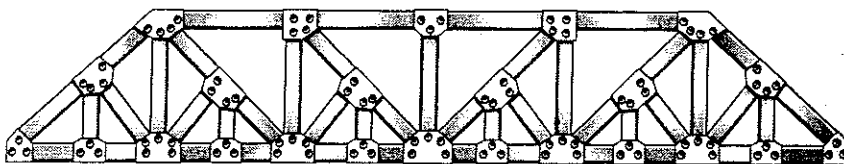

Baltimore or subdivided Pratt
(e)

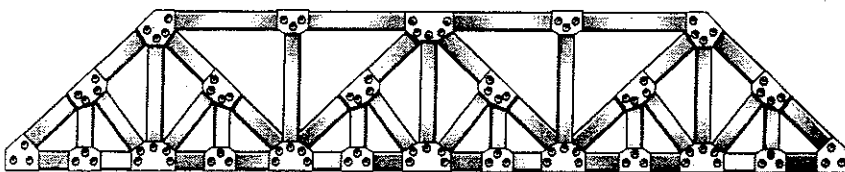

subdivided Warren
(f)

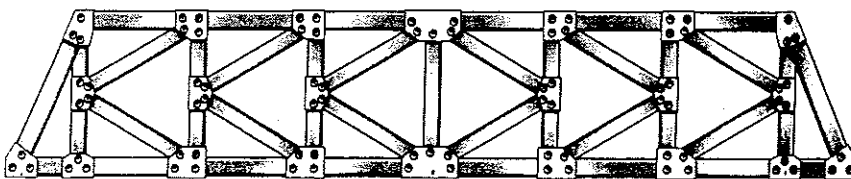

K-truss
(g)

Fig. 3-5

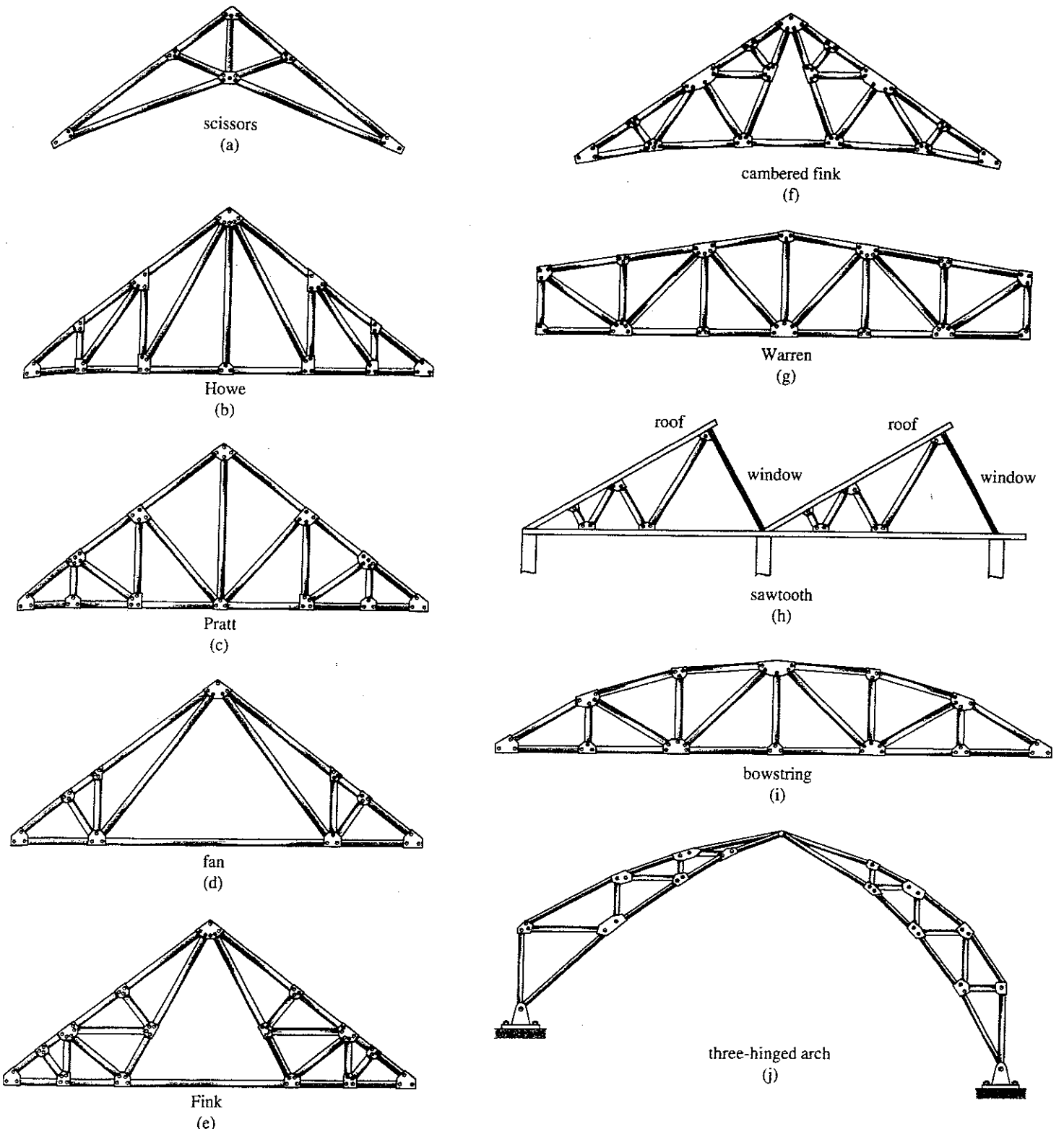
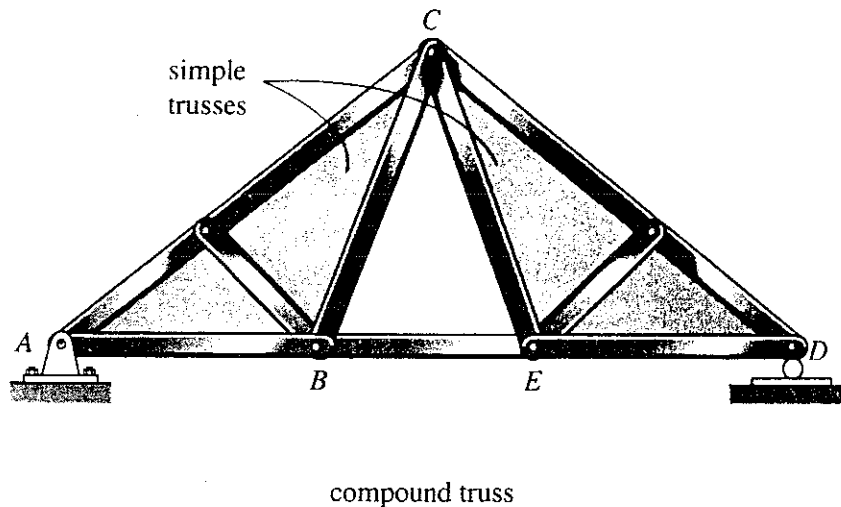

Fig. 3-3

Type 1: The trusses may be connected by a common joint and bar. An example is given in Fig. 3-11a, where the shaded truss ABC is connected to the shaded truss CDE in this manner.



(a)

Fig. 3-11

Type 2: The trusses may be joined by three bars as in the case of the shaded truss ABC connected to the larger truss DEF, Fig. 3-11b.

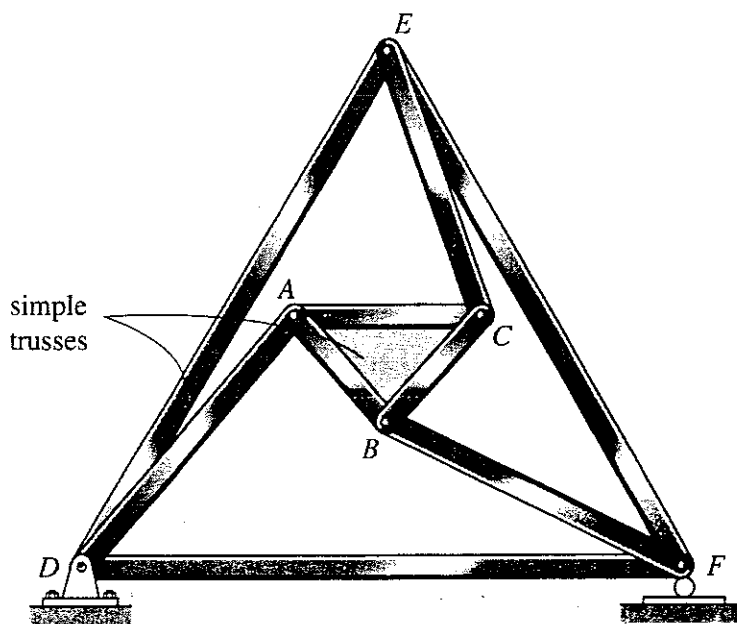

(b)